

G900 Million Lock Cam Lock

Features

- Suitable for vending machine, ATM and coin locker applications, etc.
- Reversible key can only be removed when locked (90° rotation), and ensures that the application is properly locked
- 1 million key changes available. Master key system available on request (max. 2,520 key changes per master key)
- Keys can be shared with other *Million Lock* series

Notes

- Key number is stamped on the screw part (※ marked on left drawing) of the body

Cut Out Dimensions

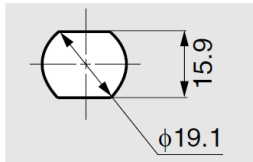

Standard type

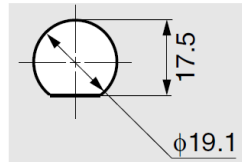

Master Key system type

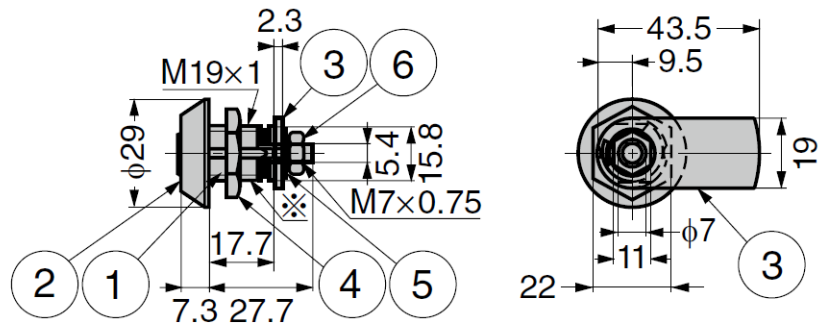
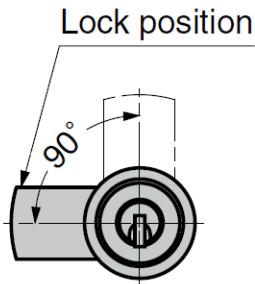
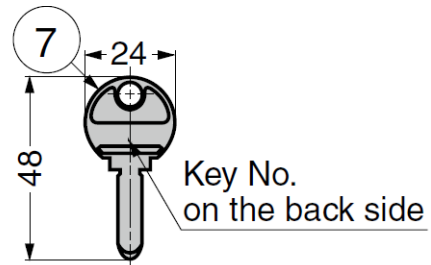
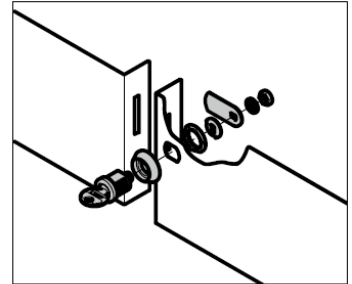

No.	Part Name	Material	Finish
①	Body	Brass	Chrome
②	Ring		
③	Cam	Steel (SPCC)	Coloured Zinc Chromate
④	Hex Nut	Steel (SS)	
⑤	Washer	Steel	Nickel
⑥	Hex Nut	Steel (SS)	Coloured Zinc Chromate
⑦	Key	Brass	Nickel

Part No.	Key Type	Door Thickness
G900-B	Keyed Differently	0.8 ~ 8
G900-D	Keyed Alike	